



## **Vegetation management report**

For Lot: 34 Plan: M341354

12/02/2024

This publication has been compiled by Operations Support, Department of Resources.

© State of Queensland, (2024)

The Queensland Government supports and encourages the dissemination and exchange of its information. The copyright in this publication is licensed under a Creative Commons - Attribution 4.0 International (CC BY) licence.

Under this licence you are free, without having to seek our permission, to use this publication in accordance with the licence terms.



You must keep intact the copyright notice and attribute the State of Queensland as the source of the publication.

Note: Some content in this publication may have different licence terms as indicated.

For more information on this licence, visit <https://creativecommons.org/licenses/by/4.0/>

The information contained herein is subject to change without notice. The Queensland Government shall not be liable for technical or other errors or omissions contained herein. The reader/user accepts all risks and responsibility for losses, damages, costs and other consequences resulting directly or indirectly from using this information.

# Recent changes

## Updated mapping

Updated vegetation mapping was released on 22 November 2023 and includes the most recent Queensland Herbarium scientific updates to the Regulated Vegetation Management Map, regional ecosystems, essential habitat, wetland and high-value regrowth mapping.

The Department of Environment and Science have also updated their koala protection mapping to align with the Queensland Herbarium scientific updates.

The latest version (v10) of the Protected Plants Flora Survey Trigger Map (trigger map) was released on 6 September 2023.

## Overview

Based on the lot on plan details you have supplied, this report provides the following detailed information:

**Property details** - information about the specified Lot on Plan, lot size, local government area, bioregion(s), subregion(s) and catchment(s);

**Vegetation management framework** - an explanation of the application of the framework and contact details for the Department of Resources who administer the framework;

**Vegetation management framework details for the specified Lot on Plan** including:

- the vegetation management categories on the property;
- the vegetation management regional ecosystems on the property;
- vegetation management watercourses or drainage features on the property;
- vegetation management wetlands on the property;
- vegetation management essential habitat on the property;
- whether any area management plans are associated with the property;
- whether the property is coastal or non-coastal; and
- whether the property is mapped as Agricultural Land Class A or B;

**Protected plant framework** - an explanation of the application of the framework and contact details for the Department of Environment and Science who administer the framework, including:

- high risk areas on the protected plant flora survey trigger map for the property;

**Koala protection framework** - an explanation of the application of the framework and contact details for the Department of Environment and Science who administer the framework; and

**Koala protection framework details for the specified Lot on Plan** including:

- the koala district the property is located in;
- koala priority areas on the property;
- core and locally refined koala habitat areas on the property;
- whether the lot is located in an identified koala broad-hectare area; and
- koala habitat regional ecosystems on the property for core koala habitat areas.

This information will assist you to determine your options for managing vegetation under:

- the vegetation management framework, which may include:

- exempt clearing work;
- accepted development vegetation clearing code;
- an area management plan;
- a development approval;

- the protected plant framework, which may include:

- the need to undertake a flora survey;
- exempt clearing;
- a protected plant clearing permit;

- the koala protection framework, which may include:

- exempted development;
- a development approval;
- the need to undertake clearing sequentially and in the presence of a koala spotter.

## Other laws

The clearing of native vegetation is regulated by both Queensland and Australian legislation, and some local governments also regulate native vegetation clearing. You may need to obtain an approval or permit under another Act, such as the Commonwealth Government's *Environment Protection and Biodiversity Conservation Act 1999* (EPBC Act). Section 8 of this guide provides contact details of other agencies you should confirm requirements with, before commencing vegetation clearing.

# Table of Contents

1. Property details . . . . .	6
1.1 Tenure and title area . . . . .	6
1.2 Property location . . . . .	6
2. Vegetation management framework (administered by the Department of Resources) . . . . .	7
2.1 Exempt clearing work . . . . .	7
2.2 Accepted development vegetation clearing codes . . . . .	7
2.3 Area management plans . . . . .	8
2.4 Development approvals . . . . .	8
2.5. Contact information for the Department of Resources . . . . .	8
3. Vegetation management framework for Lot: 34 Plan: M341354 . . . . .	9
3.1 Vegetation categories . . . . .	9
3.2 Regional ecosystems . . . . .	10
3.3 Watercourses . . . . .	10
3.4 Wetlands . . . . .	10
3.5 Essential habitat . . . . .	10
3.6 Area Management Plan(s) . . . . .	11
3.7 Coastal or non-coastal . . . . .	12
3.8 Agricultural Land Class A or B . . . . .	12
4. Vegetation management framework maps . . . . .	13
4.1 Regulated vegetation management map . . . . .	14
4.2 Vegetation management supporting map . . . . .	15
4.3 Coastal/non-coastal map . . . . .	16
4.4 Agricultural Land Class A or B as per State Planning Policy: State Interest for Agriculture . . . . .	17
5. Protected plants framework (administered by the Department of Environment and Science (DES)) . . . . .	18
5.1 Clearing in high risk areas on the flora survey trigger map . . . . .	18
5.2 Clearing outside high risk areas on the flora survey trigger map . . . . .	18
5.3 Exemptions . . . . .	18
5.4 Contact information for DES . . . . .	18
5.5 Protected plants flora survey trigger map . . . . .	19
6. Koala protection framework (administered by the Department of Environment and Science (DES)) . . . . .	21
6.1 Koala mapping . . . . .	21
6.2 Koala habitat planning controls . . . . .	22
6.3 Koala Conservation Plan clearing requirements . . . . .	23
6.4 Contact information for DES . . . . .	23
7. Koala protection framework details for Lot: 34 Plan: M341354 . . . . .	23
7.1 Koala districts . . . . .	23
7.2 Koala priority area, koala habitat area and identified koala broad-hectare area map . . . . .	24
7.3 Koala habitat regional ecosystems for core koala habitat areas . . . . .	25
8. Other relevant legislation contacts list . . . . .	26

# 1. Property details

## 1.1 Tenure and title area

All of the lot, plan, tenure and title area information associated with property Lot: 34 Plan: M341354, are listed in Table 1.

**Table 1: Lot, plan, tenure and title area information for the property**

Lot	Plan	Tenure	Property title area (sq metres)
34	M341354	Freehold	647,500
B	SP327992	Easement	18,850

The tenure of the land may affect whether clearing is considered exempt clearing work or may be carried out under an accepted development vegetation clearing code.

### **Does this property have a freehold tenure and is in the Wet Tropics of Queensland World Heritage Area?**

No, this property is not located in the Wet Tropics of Queensland World Heritage Area.

## 1.2 Property location

Table 2 provides a summary of the locations for property Lot: 34 Plan: M341354, in relation to natural and administrative boundaries.

**Table 2: Property location details**

Local Government(s)
Southern Downs Regional

Bioregion(s)	Subregion(s)
Southeast Queensland	Scenic Rim

Catchment(s)
Balonne-Condamine

## 2. Vegetation management framework (administered by the Department of Resources)

The *Vegetation Management Act 1999* (VMA), the *Vegetation Management Regulation 2023*, the *Planning Act 2016* and the *Planning Regulation 2017*, in conjunction with associated policies and codes, form the Vegetation Management Framework.

The VMA does not apply to all land tenures or vegetation types. State forests, national parks, forest reserves and some tenures under the *Forestry Act 1959* and *Nature Conservation Act 1992* are not regulated by the VMA. Managing or clearing vegetation on these tenures may require approvals under these laws.

The following native vegetation is not regulated under the VMA but may require permit(s) under other laws:

- grass or non-woody herbage;
- a plant within a grassland regional ecosystem identified in the Vegetation Management Regional Ecosystem Description Database (VM REDD) as having a grassland structure; and
- a mangrove.

### 2.1 Exempt clearing work

Exempt clearing work is an activity for which you do not need to notify the Department of Resources or obtain an approval under the vegetation management framework. Exempt clearing work was previously known as exemptions.

In areas that are mapped as Category X (white in colour) on the regulated vegetation management map (see section 4.1), and where the land tenure is freehold, indigenous land and leasehold land for agriculture and grazing purposes, the clearing of vegetation is considered exempt clearing work and does not require notification or development approval under the vegetation management framework. For all other land tenures, contact the Department of Resources before commencing clearing to ensure that the proposed activity is exempt clearing work.

A range of routine property management activities are considered exempt clearing work. A list of exempt clearing work is available at

<https://www.qld.gov.au/environment/land/management/vegetation/clearing-approvals/exemptions>.

Exempt clearing work may be affected if the proposed clearing area is subject to development approval conditions, a covenant, an environmental offset, an exchange area, a restoration notice, or an area mapped as Category A. Exempt clearing work may require approval under other Commonwealth, State or Local Government laws, or local government planning schemes. Contact the Department of Resources prior to clearing in any of these areas.

### 2.2 Accepted development vegetation clearing codes

Some clearing activities can be undertaken under an accepted development vegetation clearing code. The codes can be downloaded at

<https://www.qld.gov.au/environment/land/management/vegetation/clearing-approvals/codes>

If you intend to clear vegetation under an accepted development vegetation clearing code, you must notify the Department of Resources before commencing. The information in this report will assist you to complete the online notification form.

You can complete the online form at

<https://vegetation-apps.dnrm.qld.gov.au>

## 2.3 Area management plans

Area Management Plans (AMP) provide an alternative approval system for vegetation clearing under the vegetation management framework. They list the purposes and clearing conditions that have been approved for the areas covered by the plan. It is not necessary to use an AMP, even when an AMP applies to your property.

On 8 March 2020, AMPs ended for fodder harvesting, managing thickened vegetation and managing encroachment. New notifications cannot be made for these AMPs. You will need to consider options for fodder harvesting, managing thickened vegetation or encroachment under a relevant accepted development vegetation clearing code or apply for a development approval.

New notifications can be made for all other AMPs. These will continue to apply until their nominated end date.

If an Area Management Plan applies to your property for which you can make a new notification, it will be listed in Section 3.6 of this report. Before clearing under one of these AMPs, you must first notify the Department of Resources and then follow the conditions and requirements listed in the AMP.

<https://www.qld.gov.au/environment/land/management/vegetation/clearing-approvals/area-management-plans>

## 2.4 Development approvals

If under the vegetation management framework your proposed clearing is not exempt clearing work, or is not permitted under an accepted development vegetation clearing code, or an AMP, you may be able to apply for a development approval.

Information on how to apply for a development approval is available at

<https://www.qld.gov.au/environment/land/management/vegetation/clearing-approvals/development>

## 2.5. Contact information for the Department of Resources

For further information on the vegetation management framework:

**Phone** 135VEG (135 834)

**Email** [vegetation@resources.qld.gov.au](mailto:vegetation@resources.qld.gov.au)

**Visit** <https://www.resources.qld.gov.au/?contact=vegetation> to submit an online enquiry.



### 3. Vegetation management framework for Lot: 34 Plan: M341354

#### 3.1 Vegetation categories

The vegetation categories on your property are shown on the regulated vegetation management map in section 4.1 of this report. A summary of vegetation categories on the subject lot are listed in Table 3. Descriptions for these categories are shown in Table 4.

**Table 3: Vegetation categories for subject property. Total area: 64.74ha**

Vegetation category	Area (ha)
Category B	63.8
Category X	0.9

**Table 4: Description of vegetation categories**

Category	Colour on Map	Description	Requirements / options under the vegetation management framework
A	red	Compliance areas, environmental offset areas and voluntary declaration areas	Special conditions apply to Category A areas. Before clearing, contact the Department of Resources to confirm any requirements in a Category A area.
B	dark blue	Remnant vegetation areas	Exempt clearing work, or notification and compliance with accepted development vegetation clearing codes, area management plans or development approval.
C	light blue	High-value regrowth areas	Exempt clearing work, or notification and compliance with managing Category C regrowth vegetation accepted development vegetation clearing code.
R	yellow	Regrowth within 50m of a watercourse or drainage feature in the Great Barrier Reef catchment areas	Exempt clearing work, or notification and compliance with managing Category R regrowth accepted development vegetation clearing code or area management plans.
X	white	Clearing on freehold land, indigenous land and leasehold land for agriculture and grazing purposes is considered exempt clearing work under the vegetation management framework. Contact the Department of Resources to clarify whether a development approval is required for other State land tenures.	No permit or notification required on freehold land, indigenous land and leasehold land for agriculture and grazing. A development approval may be required for some State land tenures.

#### Property Map of Assessable Vegetation (PMAV)

The following Property Map of Assessable Vegetation (PMAVs) may be present on this property:

**Reference number**

2018/001452

## 3.2 Regional ecosystems

The endangered, of concern and least concern regional ecosystems on your property are shown on the vegetation management supporting map in section 4.2 and are listed in Table 5.

A description of regional ecosystems can be accessed online at <https://www.qld.gov.au/environment/plants-animals/plants/ecosystems/descriptions/>

**Table 5: Regional ecosystems present on subject property**

Regional Ecosystem	VMA Status	Category	Area (Ha)	Short Description	Structure Category
12.8.1	Least concern	B	13.60	Eucalyptus campanulata tall open forest on Cainozoic igneous rocks	Mid-dense
12.8.14	Least concern	B	35.10	Eucalyptus eugenioides, E. biturbinata, E. melliodora +/- E. tereticornis, Corymbia intermedia open forest on Cainozoic igneous rocks	Mid-dense
12.8.9	Least concern	B	15.10	Lophostemon confertus open forest on Cainozoic igneous rocks	Mid-dense
non-rem	None	X	0.94	None	None

Please note:

1. All area and area derived figures included in this table have been calculated via reprojecting relevant spatial features to Albers equal-area conic projection (central meridian = 146, datum Geocentric Datum of Australia 1994). As a result, area figures may differ slightly if calculated for the same features using a different co-ordinate system.
2. If Table 5 contains a Category 'plant', please be aware that this refers to 'plantations' such as forestry, and these areas are considered non-remnant under the VMA.

The VMA status of the regional ecosystem (whether it is endangered, of concern or least concern) also determines if any of the following are applicable:

- exempt clearing work;
- accepted development vegetation clearing codes;
- performance outcomes in State Code 16 of the State Development Assessment Provisions (SDAP).

## 3.3 Watercourses

Vegetation management watercourses and drainage features for this property are shown on the vegetation management supporting map in section 4.2.

## 3.4 Wetlands

There are no vegetation management wetlands present on this property.

## 3.5 Essential habitat

Under the VMA, essential habitat for protected wildlife is native wildlife prescribed under the *Nature Conservation Act 1992* (NCA) as critically endangered, endangered, vulnerable or near-threatened wildlife.

Essential habitat for protected wildlife includes suitable habitat on the lot, or where a species has been known to occur up to 1.1 kilometres from a lot on which there is assessable vegetation. These important habitat areas are protected under the VMA.

Any essential habitat on this property will be shown as blue hatching on the vegetation supporting map in section 4.2.

If essential habitat is identified on the lot, information about the protected wildlife species is provided in Table 6 below. The numeric labels on the vegetation management supporting map can be cross referenced with Table 6 to outline the essential habitat factors for that particular species. There may be essential habitat for more than one species on each lot, and areas of

Category A, Category B and Category C can be mapped as Essential Habitat.

Essential habitat is compiled from a combination of species habitat models and buffered species records. Regional ecosystem is a mandatory essential habitat factor, unless otherwise stated. Essential habitat, for protected wildlife, means an area of vegetation shown on the Regulated Vegetation Management Map -

- 1) that has at least 3 essential habitat factors for the protected wildlife that must include any essential habitat factors that are stated as mandatory for the protected wildlife in the essential habitat database. Essential habitat factors are comprised of - regional ecosystem (mandatory for most species), vegetation community, altitude, soils, position in landscape; or
- 2) in which the protected wildlife, at any stage of its life cycle, is located.

If there is no essential habitat mapping shown on the vegetation management supporting map for this lot, and there is no table in the sections below, it confirms that there is no essential habitat on the lot.

### Category A and/or Category B and/or Category C

**Table 6: Essential habitat in Category A and/or Category B and/or Category C**

Label	Scientific Name	Common Name	NCA Status	Vegetation Community	Altitude	Soils	Position in Landscape
1171	<i>Calyptorhynchus lathamii</i>	glossy black-cockatoo	V	Lowland and highland eucalypt forest and woodland, including riparian, callitris and brigalow scrub areas, with <i>Casuarina</i> ( <i>C. glauca</i> , <i>C. cristata</i> )/ <i>Allocasuarina</i> spp. ( <i>A. torulosa</i> , <i>A. littoralis</i> ). Nest in large vertical hollow (1-2m deep, 25-50cm diameter) up to 28m above ground in tall slightly isolated tree usually near principal food source ( <i>Allocasuarina</i> / <i>Casuarina</i> ).	Sea level to 1200m.	None	None
890	<i>Petrogale penicillata</i>	brush-tailed rock-wallaby	V	Rocky outcrops, scarps, cliff faces, and gorges, with abundant ledges, caves and narrow access routes, covered in sparse open dry sclerophyll forest and open woodland, also in rainforest (dry) gullies and wet forest, with nearby grassy areas (particularly short green grass with forbs).	100-1300m.	None	Rocky outcrops, scarps, cliff faces, gorges, and adjoining flats.

Label	Regional Ecosystem (mandatory unless otherwise specified)
1171	6.3.1, 6.3.2, 6.3.3, 6.3.4, 6.3.5, 6.3.8, 6.3.9, 6.3.16, 6.3.17, 6.3.18, 6.3.24, 6.3.25, 6.4.1, 6.4.2, 6.4.3, 6.5.1, 6.5.2, 6.5.3, 6.5.5, 6.5.17, 6.5.19, 6.7.2, 6.7.5, 6.7.6, 8.2.1, 8.2.3, 8.2.4, 8.2.6, 8.2.7, 8.2.8, 8.2.12, 8.2.13, 8.2.14, 8.3.2, 8.3.3, 8.3.5, 8.3.6, 8.3.8, 8.3.11, 8.3.13, 8.5.1, 8.5.2, 8.5.3, 8.5.5, 8.5.6, 8.9.1, 8.11.1, 8.11.3, 8.11.4, 8.11.5, 8.11.6, 8.11.8, 8.12.4, 8.12.5, 8.12.6, 8.12.7, 8.12.8, 8.12.9, 8.12.12, 8.12.14, 8.12.20, 8.12.22, 8.12.23, 8.12.25, 8.12.26, 8.12.27, 8.12.31, 8.12.32, 9.3.1, 9.3.2, 9.3.3, 9.3.4, 9.3.5, 9.3.6, 9.3.7, 9.3.8, 9.3.9, 9.3.11, 9.3.13, 9.3.14, 9.3.15, 9.3.16, 9.3.17, 9.3.18, 9.3.19, 9.3.20, 9.3.21, 9.3.22, 9.3.23, 9.4.1, 9.4.2, 9.4.3, 9.5.1, 9.5.3, 9.5.4, 9.5.5, 9.5.6, 9.5.7, 9.5.8, 9.5.9, 9.5.10, 9.5.11, 9.5.12, 9.5.16, 9.7.1, 9.7.2, 9.7.3, 9.7.5, 9.7.6, 9.8.1, 9.8.2, 9.8.4, 9.8.5, 9.8.6, 9.8.9, 9.8.10, 9.8.11, 9.10.1, 9.10.3, 9.10.4, 9.10.5, 9.10.6, 9.10.7, 9.10.8, 9.11.1, 9.11.2, 9.11.3, 9.11.4, 9.11.5, 9.11.7, 9.11.10, 9.11.11, 9.11.12, 9.11.13, 9.11.15, 9.11.16, 9.11.17, 9.11.18, 9.11.19, 9.11.23, 9.11.26, 9.11.28, 9.11.29, 9.11.31, 9.11.32, 9.12.1, 9.12.2, 9.12.3, 9.12.4, 9.12.5, 9.12.6, 9.12.7, 9.12.10, 9.12.11, 9.12.12, 9.12.13, 9.12.16, 9.12.17, 9.12.18, 9.12.19, 9.12.20, 9.12.21, 9.12.22, 9.12.23, 9.12.24, 9.12.26, 9.12.28, 9.12.30, 9.12.31, 9.12.33, 9.12.35, 9.12.37, 9.12.39, 11.2.1, 11.2.2, 11.2.5, 11.3.1, 11.3.2, 11.3.3, 11.3.4, 11.3.6, 11.3.7, 11.3.8, 11.3.9, 11.3.10, 11.3.12, 11.3.13, 11.3.14, 11.3.15, 11.3.16, 11.3.17, 11.3.18, 11.3.19, 11.3.23, 11.3.25, 11.3.26, 11.3.27, 11.3.28, 11.3.29, 11.3.30, 11.3.35, 11.3.36, 11.3.37, 11.3.38, 11.3.39, 11.4.2, 11.4.3, 11.4.5, 11.4.7, 11.4.8, 11.4.9, 11.4.10, 11.4.12, 11.4.13, 11.5.1, 11.5.2, 11.5.3, 11.5.4, 11.5.5, 11.5.7, 11.5.8, 11.5.9, 11.5.12, 11.5.13, 11.5.14, 11.5.16, 11.5.17, 11.5.20, 11.5.21, 11.7.1, 11.7.2, 11.7.4, 11.7.6, 11.8.1, 11.8.2, 11.8.4, 11.8.5, 11.8.8, 11.8.9, 11.8.11, 11.8.12, 11.8.14, 11.8.15, 11.9.1, 11.9.2, 11.9.3, 11.9.5, 11.9.6, 11.9.7, 11.9.9, 11.9.10, 11.9.13, 11.9.14, 11.10.1, 11.10.2, 11.10.3, 11.10.4, 11.10.5, 11.10.6, 11.10.7, 11.10.9, 11.10.11, 11.10.12, 11.10.13, 11.11.1, 11.11.3, 11.11.4, 11.11.6, 11.11.7, 11.11.8, 11.11.9, 11.11.10, 11.11.11, 11.11.13, 11.11.14, 11.11.15, 11.11.16, 11.11.19, 11.11.20, 11.12.1, 11.12.2, 11.12.3, 11.12.5, 11.12.6, 11.12.7, 11.12.8, 11.12.9, 11.12.10, 11.12.11, 11.12.12, 11.12.13, 11.12.14, 11.12.15, 11.12.17, 11.12.19, 11.12.20, 11.12.21, 12.2.5, 12.2.6, 12.2.9, 12.2.13, 12.2.14, 12.3.11, 12.5.1, 12.5.2, 12.5.3, 12.5.4, 12.5.6, 12.6.1, 12.6.2, 12.6.8, 12.6.10, 12.6.11, 12.6.12, 12.6.14, 12.6.16, 12.6.18, 12.6.19, 12.6.20, 12.6.21, 12.6.23, 12.6.24, 12.6.25, 12.9-10.2, 12.9-10.4, 12.9-10.5, 12.9-10.6, 12.9-10.9, 12.9-10.12, 12.9-10.14, 12.9-10.17, 12.9-10.19, 12.9-10.20, 12.11.2, 12.11.3, 12.11.5, 12.11.6, 12.11.9, 12.11.15, 12.11.23, 12.11.24, 12.11.25, 12.11.27, 12.12.2, 12.12.5, 12.12.6, 12.12.9, 12.12.11, 12.12.15, 12.12.19, 12.12.20, 12.12.23, 12.12.26, 13.3.1, 13.3.2, 13.3.3, 13.3.4, 13.3.5, 13.3.7, 13.9.2, 13.11.1, 13.11.2, 13.11.3, 13.11.4, 13.11.5, 13.11.6, 13.11.8, 13.12.1, 13.12.2, 13.12.3, 13.12.4, 13.12.5, 13.12.8, 13.12.9, 13.12.10
890	11.3.25, 11.3.4, 11.5.20, 11.7.5, 11.8.15, 11.8.2, 11.8.3, 11.8.4, 11.8.5, 11.8.8, 11.9.4, 11.9.7, 11.9.9, 11.9.13, 11.10.1, 11.10.4, 11.10.7, 11.11.1, 11.11.4, 11.11.5, 11.11.9, 11.11.10, 11.11.15, 11.12.1, 11.12.2, 11.12.3, 11.12.4, 11.12.5, 11.12.6, 12.3.2, 12.3.3, 12.3.7, 12.3.9, 12.3.11, 12.3.19, 12.5.1, 12.5.2, 12.5.6, 12.5.7, 12.7.1, 12.7.2, 12.8.1, 12.8.2, 12.8.3, 12.8.4, 12.8.5, 12.8.6, 12.8.7, 12.8.8, 12.8.9, 12.8.10, 12.8.11, 12.8.12, 12.8.13, 12.8.14, 12.8.16, 12.8.17, 12.8.18, 12.8.19, 12.8.20, 12.8.21, 12.8.23, 12.8.24, 12.8.25, 12.8.26, 12.9-10.2, 12.9-10.3, 12.9-10.4, 12.9-10.5, 12.9-10.6, 12.9-10.7, 12.9-10.8, 12.9-10.12, 12.9-10.14, 12.9-10.15, 12.9-10.16, 12.9-10.17, 12.9-10.18, 12.9-10.19, 12.9-10.20, 12.9-10.21, 12.9-10.25, 12.9-10.27, 12.9-10.28, 12.11.2, 12.11.3, 12.11.5, 12.11.6, 12.11.7, 12.11.8, 12.11.9, 12.11.10, 12.11.11, 12.11.12, 12.11.14, 12.11.15, 12.11.17, 12.11.18, 12.11.19, 12.11.22, 12.11.24, 12.11.25, 12.11.26, 12.11.27, 12.11.28, 12.12.2, 12.12.3, 12.12.5, 12.12.6, 12.12.7, 12.12.8, 12.12.9, 12.12.10, 12.12.11, 12.12.12, 12.12.13, 12.12.14, 12.12.15, 12.12.16, 12.12.17, 12.12.18, 12.12.22, 12.12.23, 12.12.24, 12.12.25, 12.12.26, 12.12.28, 13.3.3, 13.3.5, 13.3.7, 13.9.2, 13.11.1, 13.11.2, 13.11.3, 13.11.4, 13.11.5, 13.11.6, 13.11.7, 13.11.8, 13.11.9, 13.12.1, 13.12.2, 13.12.3, 13.12.4, 13.12.5, 13.12.6, 13.12.8, 13.12.9, 13.12.10, 13.12.11

## 3.6 Area Management Plan(s)

Nil

### 3.7 Coastal or non-coastal

For the purposes of the accepted development vegetation clearing codes and State Code 16 of the State Development Assessment Provisions (SDAP), this property is regarded as\*

Coastal

\*See also Map 4.3

### 3.8 Agricultural Land Class A or B

The following can be used to identify Agricultural Land Class A or B areas under the "Managing regulated regrowth vegetation" accepted development vegetation clearing code:

**Does this lot contain land that is mapped as Agricultural Land Class A or B in the State Planning Interactive Mapping System?**

No Class A

No Class B

Note - This confirms Agricultural Land Classes as per the State Planning Interactive Mapping System only. This response does not include Agricultural Land Classes identified under local government planning schemes. For further information, check the Planning Scheme for your local government area.

See Map 4.4 to identify the location and extent of Class A and/or Class B Agricultural land on Lot: 34 Plan: M341354.

## 4. Vegetation management framework maps

Vegetation management maps included in this report may also be requested individually at:

<https://www.resources.qld.gov.au/qld/environment/land/vegetation/vegetation-map-request-form>

### **Regulated vegetation management map**

The regulated vegetation management map shows vegetation categories needed to determine clearing requirements. These maps are updated monthly to show new [property maps of assessable vegetation \(PMAV\)](#).

### **Vegetation management supporting map**

The vegetation management supporting map provides information on regional ecosystems, wetlands, watercourses and essential habitat.

### **Coastal/non-coastal map**

The coastal/non-coastal map confirms whether the lot, or which parts of the lot, are considered coastal or non-coastal for the purposes of the accepted development vegetation clearing codes and State Code 16 of the State Development Assessment Provisions (SDAP).

### **Agricultural Land Class A or B as per State Planning Policy: State Interest for Agriculture**

The Agricultural Land Class map confirms the location and extent of land mapped as Agricultural Land Classes A or B as identified on the State Planning Interactive Mapping System. Please note that this map does not include areas identified as Agricultural Land Class A or B in local government planning schemes. This map can be used to identify Agricultural Land Class A or B areas under the "Managing regulated regrowth vegetation" accepted development vegetation clearing code.

# 4.1 Regulated vegetation management map

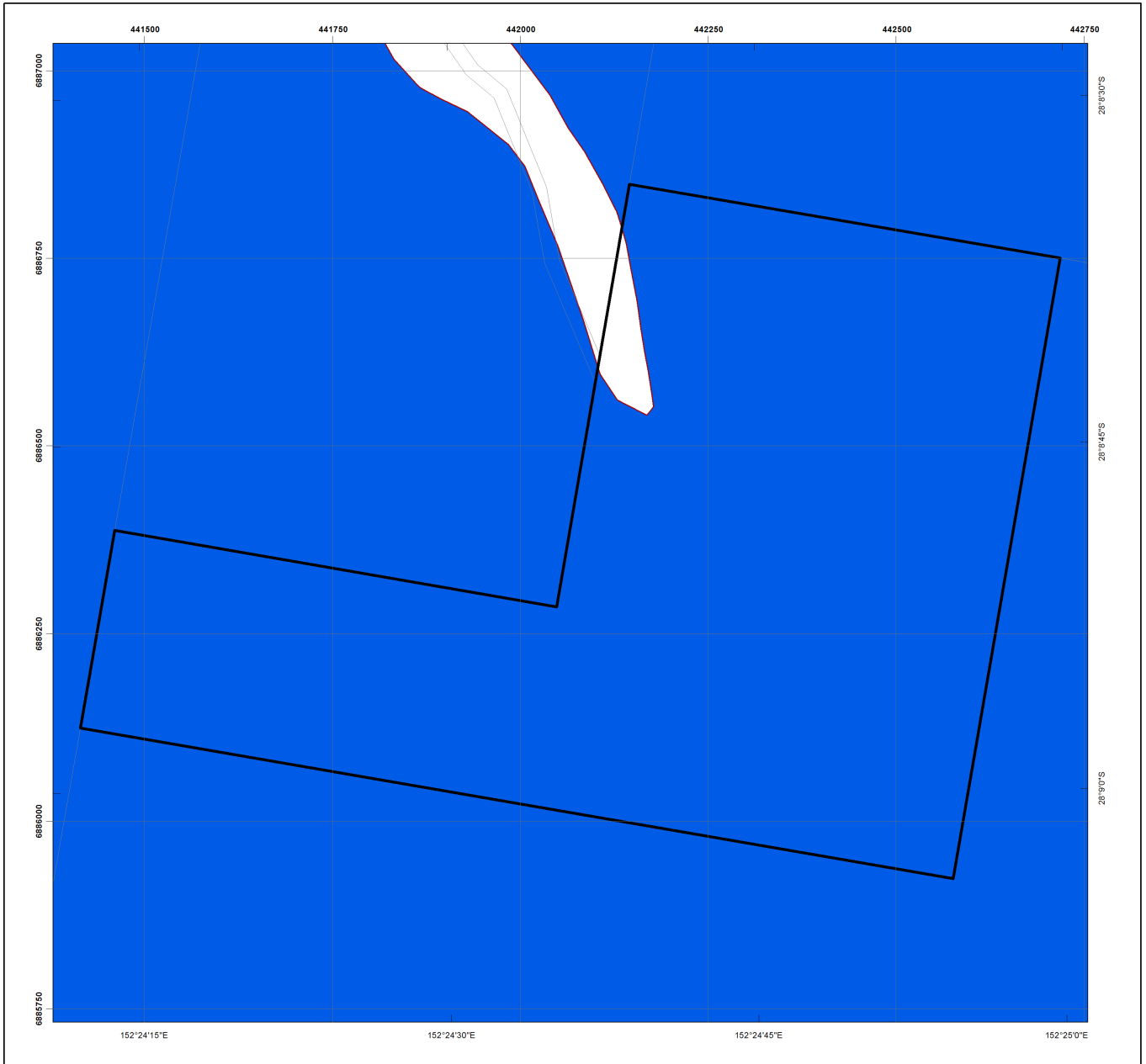

## Regulated Vegetation Management Map

### Legend

- Selected Lot and Plan
- Category A area (Vegetation offsets/compliance notices/VDecs)
- Category B area (Remnant vegetation)
- Category C area (High-value regrowth vegetation)
- Category R area (Reef regrowth watercourse vegetation)
- Category X area (Exempt clearing work on Freehold, Indigenous and Leasehold land)
- Water
- Other land parcel boundaries

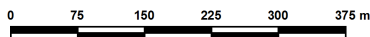
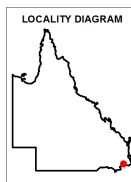

This product is projected into:  
GDA 1994 MGA Zone 56

### Disclaimer:

While every care is taken to ensure the accuracy of this product, the Department of Resources makes no representations or warranties about its accuracy, reliability, completeness or suitability for any particular purpose and disclaims all responsibility and all liability (including without limitation, liability in negligence) for all expenses, losses, damages (including indirect or consequential damage) and costs which you might incur as a result of the product being inaccurate or incomplete in any way and for any reason.

Additional information required for the assessment of vegetation values is provided in the accompanying "Vegetation Management Supporting map". For further information go to the web site: [www.resources.qld.gov.au](http://www.resources.qld.gov.au) or contact the Department of Resources.

Digital data for the regulated vegetation management map is available from the Queensland Spatial Portal at <http://www.information.qld.gov.au/>

Land parcel boundaries are provided as locational aid only.

This map is updated on a monthly basis to ensure new PMAVs are included as they are approved.

## 4.2 Vegetation management supporting map

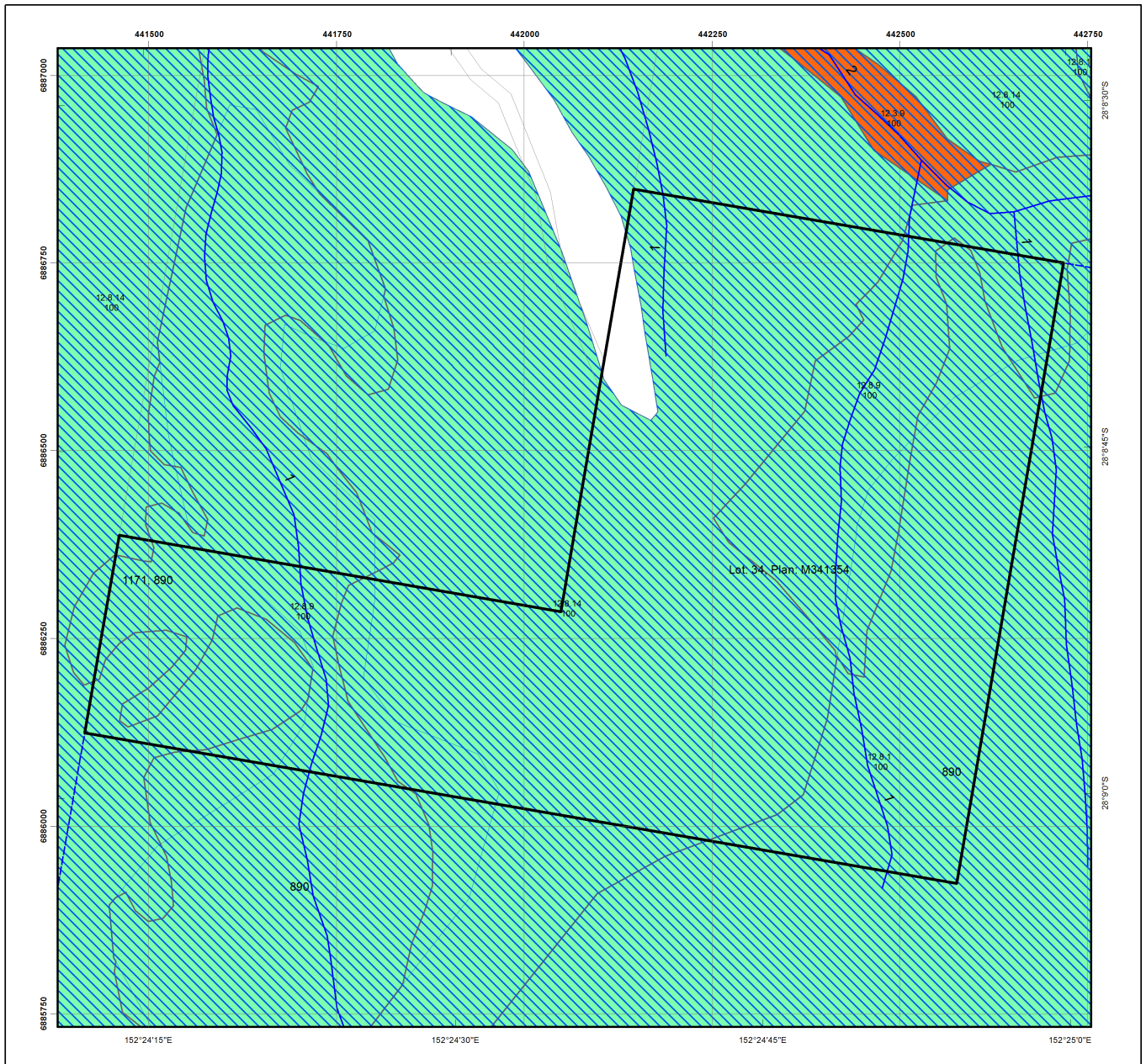

### Vegetation Management Supporting Map

#### Legend

- Selected Lot and Plan
- Category A or B area containing endangered regional ecosystems
- Category A or B area containing of concern regional ecosystems
- Category A or B area that is a least concern regional ecosystem
- Category C or R area containing endangered regional ecosystems
- Category C or R area containing of concern regional ecosystems
- Category C or R area that is a least concern regional ecosystem
- Category X area
- Water
- Wetland on the vegetation management wetlands map
- Essential habitat on the essential habitat map
- Essential habitat species record
- Watercourses and drainage features on the vegetation management watercourse and drainage features map (Stream order shown as black number against stream where available)
- Highway
- Connector
- Street/Local Road
- National Parks, State Forest and other reserves
- Other land parcel boundaries

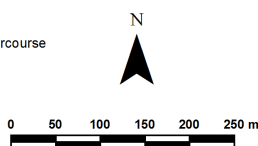
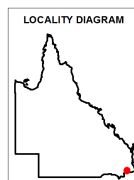

This product is projected into:  
GDA 1994 MGA Zone 56

Labels for Essential Habitat are centred on the area of enquiry.

Regional ecosystem linework has been compiled at a scale of 1:100 000, except in designated areas where a compilation scale of 1:50 000 is available. Linework should be used as a guide only. The positional accuracy of RE data mapped at a scale of 1:100 000 is +/- 100 metres.

#### Disclaimer:

While every care is taken to ensure the accuracy of this product, the Department of Resources makes no representations or warranties about its accuracy, reliability, completeness or suitability for any particular purpose and disclaims all responsibility and all liability (including without limitation, liability in negligence) for all expenses, losses, damages (including indirect or consequential damage) and costs which you might incur as a result of the product being inaccurate or incomplete in any way and for any reason.

Additional information may be required for the purposes of land clearing or assessment of a regional ecosystem map or PMAV applications. For further information go to the web site: [www.resources.qld.gov.au](http://www.resources.qld.gov.au) or contact the Department of Resources.

Digital data for the vegetation management watercourse and drainage feature map, vegetation management wetlands map, essential habitat map and the vegetation management remnant and regional ecosystem map are available from the Queensland Spatial Portal at <http://www.information.qld.gov.au/>



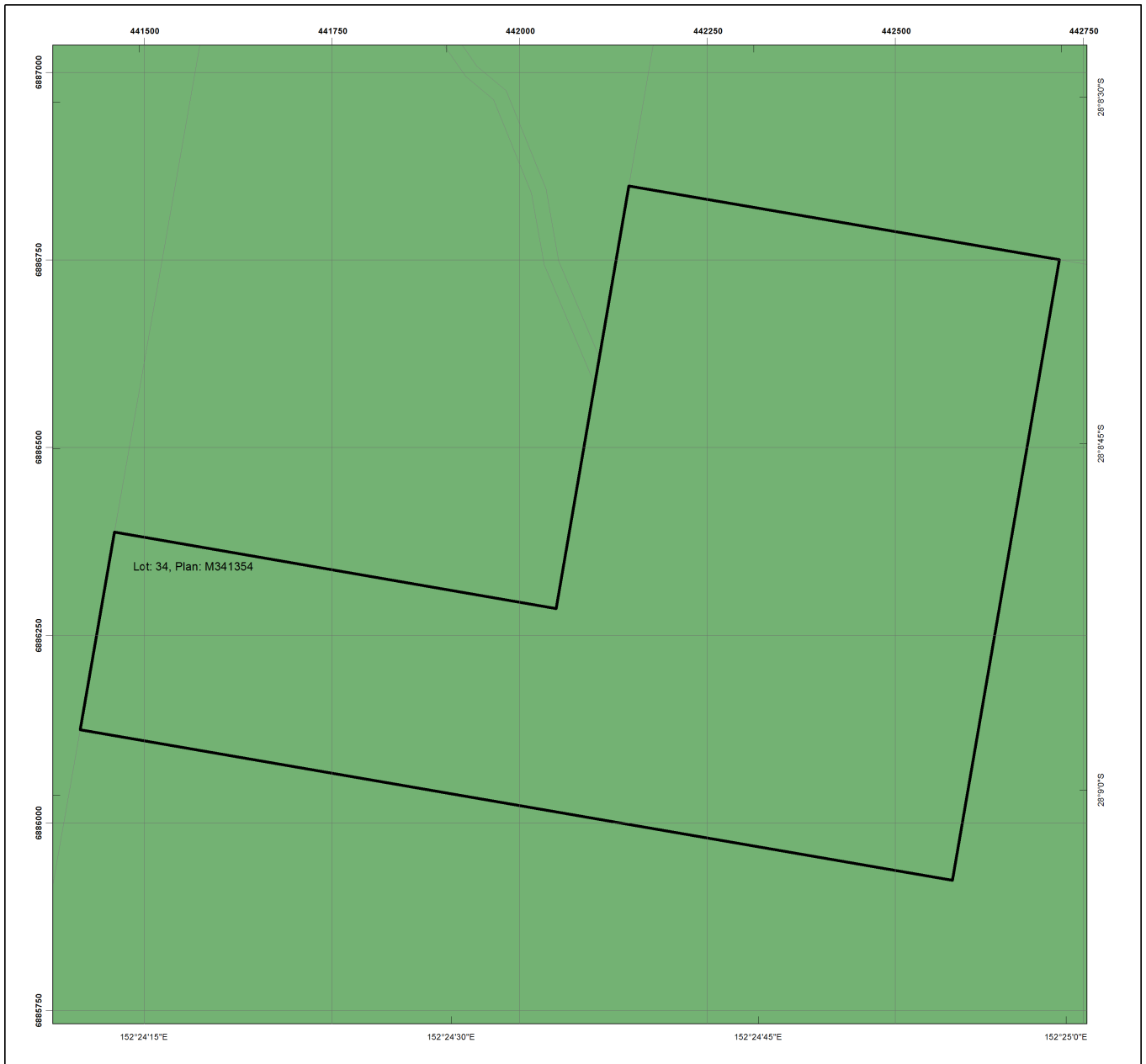

Land parcel boundaries are provided as locational aid only.

# 4.3 Coastal/non-coastal map



## Coastal/Non Coastal Map

### Legend

-  Selected Lot and Plan
-  Coastal
-  Non Coastal
-  Other land parcel boundaries

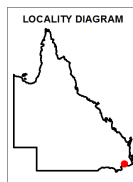

**Disclaimer:**  
 While every care is taken to ensure the accuracy of this product, the Department of Resources makes no representations or warranties about its accuracy, reliability, completeness or suitability for any particular purpose and disclaims all responsibility and all liability (including without limitation, liability in negligence) for all expenses, losses, damages (including indirect or consequential damage) and costs which you might incur as a result of the product being inaccurate or incomplete in any way and for any reason.

Land parcel boundaries shown are provided as a locational aid only.

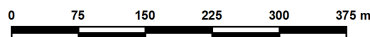

This product is projected into:  
 GDA 1994 MGA Zone 56

© The State of Queensland (Department of Resources), 2024





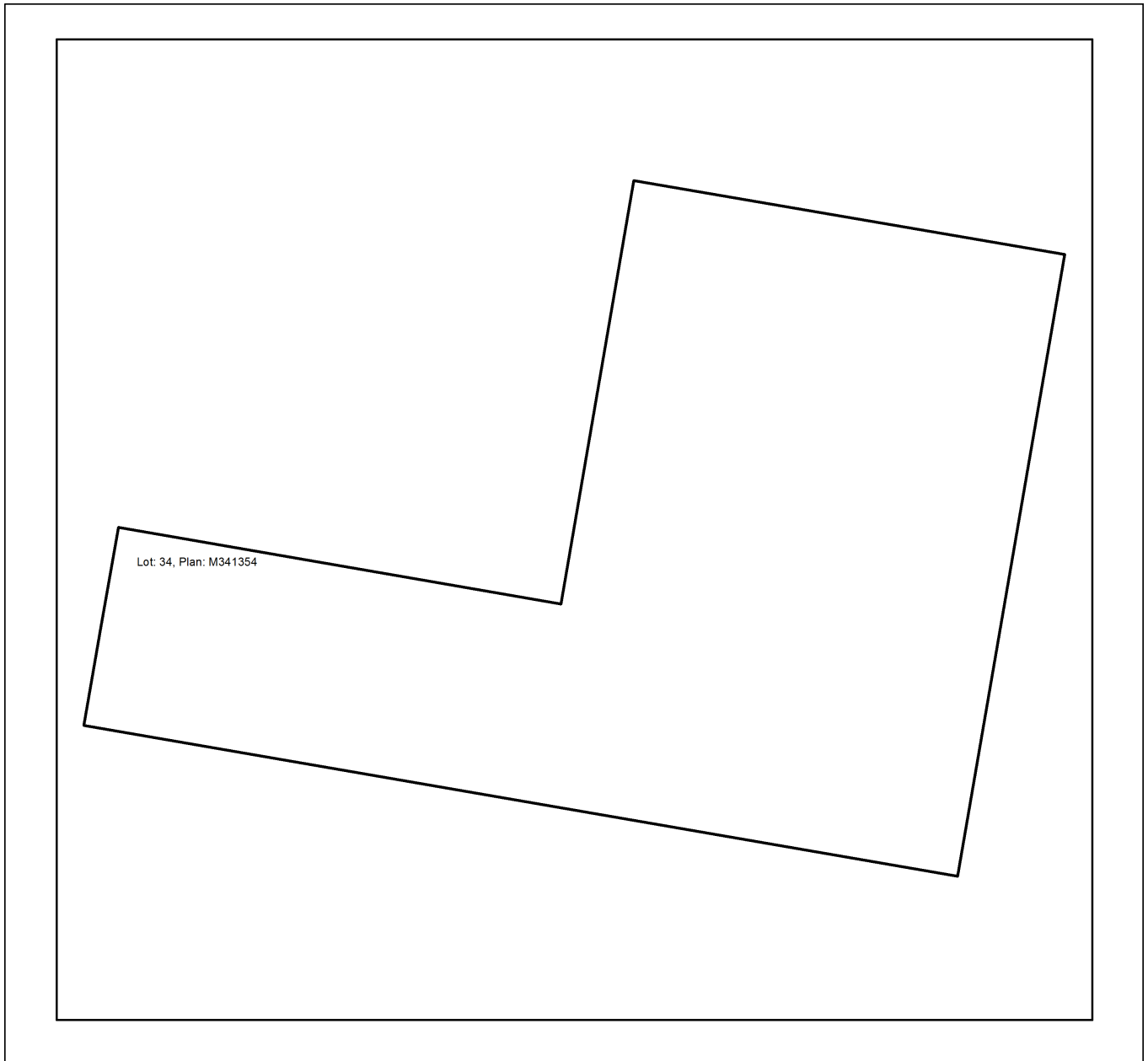





# 4.4 Agricultural Land Class A or B as per State Planning Policy: State Interest for Agriculture



## Agricultural Land Class A or B as per State Planning Policy: State Interest for Agriculture

### Legend

-  Selected Lot and Plan
-  Towns
-  Rivers and creeks
-  Freeways / motorways; Highways
-  Secondary roads; Streets
- Agricultural land class A or B
-  A
-  B
-  Not class A or B

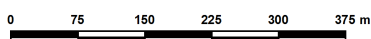
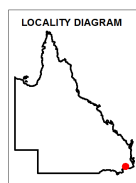

**Disclaimer**  
 Whilst every care is taken to ensure the accuracy of these details all data custodians and/or the State of Queensland makes no representations or warranties about its accuracy, reliability, completeness or suitability for any particular purpose and disclaims all responsibility and all liability (including without limitation, liability in negligence) for all expenses, losses damages (including indirect or consequential damage) and costs to which you might incur as a result of the data being inaccurate or incomplete in any way and for any reason.

This product is projected into GDA 1994 MGA Zone 56

© The State of Queensland, 2024

## 5. Protected plants framework (administered by the Department of Environment and Science (DES))

In Queensland, all plants that are native to Australia are protected plants under the [Nature Conservation Act 1992](#) (NCA). The NCA regulates the clearing of protected plants 'in the wild' (see [Operational policy: When a protected plant in Queensland is considered to be 'in the wild'](#)) that are listed as critically endangered, endangered, vulnerable or near threatened under the Act.

Please note that the protected plant clearing framework applies irrespective of the classification of the vegetation under the *Vegetation Management Act 1999* and any approval or exemptions given under another Act, for example, the *Vegetation Management Act 1999* or *Planning Regulation 2017*.

### 5.1 Clearing in high risk areas on the flora survey trigger map

The flora survey trigger map identifies high-risk areas for threatened and near threatened plants. These are areas where threatened or near threatened plants are known to exist or are likely to exist based on the habitat present. The flora survey trigger map for this property is provided in section 5.5.

If you are proposing to clear an area shown as high risk on the flora survey trigger map, a flora survey of the clearing impact area must be undertaken by a suitably qualified person in accordance with the [Flora survey guidelines](#). The main objective of a flora survey is to locate any threatened or near threatened plants that may be present in the clearing impact area.

If the flora survey identifies that threatened or near threatened plants are not present within the clearing impact area or clearing within 100m of a threatened or near threatened plant can be avoided, the clearing activity is exempt from a permit. An [exempt clearing notification form](#) must be submitted to the Department of Environment and Science, with a copy of the flora survey report, at least one week prior to clearing.

If the flora survey identifies that threatened or near threatened plants are present in, or within 100m of, the area to be cleared, a clearing permit is required before any clearing is undertaken. The flora survey report, as well as an impact management report, must be submitted with the [clearing permit application form](#).

### 5.2 Clearing outside high risk areas on the flora survey trigger map

In an area other than a high risk area, a clearing permit is only required where a person is, or becomes aware that threatened or near threatened plants are present in, or within 100m of, the area to be cleared. You must keep a copy of the flora survey trigger map for the area subject to clearing for five years from the day the clearing starts. If you do not clear within the 12 month period that the flora survey trigger map was printed, you need to print and check a new flora survey trigger map.

### 5.3 Exemptions

Many activities are 'exempt' under the protected plant clearing framework, which means that clearing of native plants that are in the wild can be undertaken for these activities with no need for a flora survey or a protected plant clearing permit. The Information sheet - General exemptions for the take of protected plants provides some of these exemptions.

Some exemptions under the NCA are the same as exempt clearing work (formerly known as exemptions) under the *Vegetation Management Act 1999* (i.e. listed in Schedule 21 of the Planning Regulations 2017) while some are different.

### 5.4 Contact information for DES

For further information on the protected plants framework:

**Phone** 1300 130 372 (and select option four)

**Email** [palm@des.qld.gov.au](mailto:palm@des.qld.gov.au)

**Visit** <https://www.qld.gov.au/environment/plants-animals/plants/protected-plants>

## 5.5 Protected plants flora survey trigger map

This map included may also be requested individually at: <https://apps.des.qld.gov.au/map-request/flora-survey-trigger/>.

### Updates to the data informing the flora survey trigger map

The flora survey trigger map will be reviewed, and updated if necessary, at least every 12 months to ensure the map reflects the most up-to-date and accurate data available.



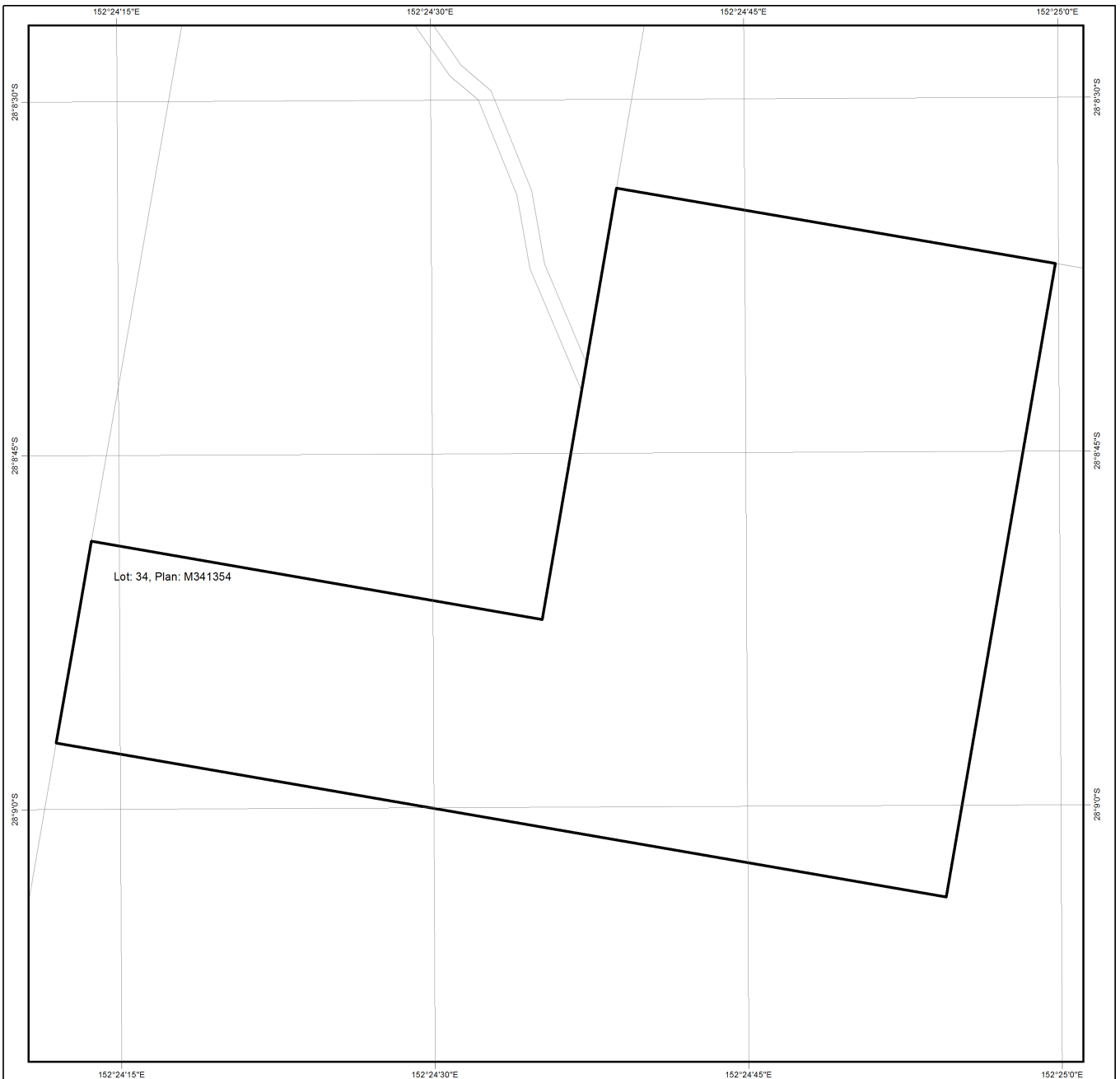

### Species information

Please note that flora survey trigger maps do not identify species associated with 'high risk areas'. While some species information may be publicly available, for example via the [Queensland Spatial Catalogue](#), the Department of Environment and Science does not provide species information on request. Regardless of whether species information is available for a particular high risk area, clearing plants in a high risk area may require a flora survey and/or clearing permit. Please see the Department of Environment and Science webpage on the [clearing of protected plants](#) for more information.



## Protected Plants Flora Survey Trigger Map

### Legend

-  Selected Lot and Plan
-  High risk area
-  Other land parcel boundaries
-  Freeways / motorways / highways
-  Secondary roads / streets

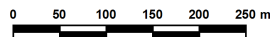
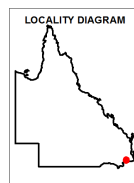

This product is projected into:  
GDA 1994 MGA Zone 56

This map shows areas where particular provisions of the Nature Conservation Act 1992 apply to the clearing of protected plants.

Land parcel boundaries are provided as locational aid only.

This map is produced at a scale relevant to the size of the area selected and should be printed as A4 size in portrait orientation.

For further information or assistance with interpretation of this product, please contact the Department of Environment and Science at [palm@des.qld.gov.au](mailto:palm@des.qld.gov.au)

**Disclaimer:**  
While every care is taken to ensure the accuracy of the data used to generate this product, the Queensland Government makes no representations or warranties about its accuracy, reliability, completeness or suitability for any particular purpose and disclaim all responsibility and all liability (including without limitation, liability in negligence) for all expenses, losses, damages (including indirect or consequential damages) and costs which might be incurred as a consequence of reliance on the data, or as a result of the data being inaccurate or incomplete in any way and for any reason.

© The State of Queensland (Department of Environment and Science), 2024

## 6. Koala protection framework (administered by the Department of Environment and Science (DES))

The koala (*Phascolarctos cinereus*) is listed in Queensland as endangered by the Queensland Government under *Nature Conservation Act 1992* and by the Australian Government under the *Environment Protection and Biodiversity Conservation Act 1999*.

The Queensland Government's koala protection framework is comprised of the *Nature Conservation Act 1992*, the Nature Conservation (Animals) Regulation 2020, the Nature Conservation (Koala) Conservation Plan 2017, the *Planning Act 2016* and the Planning Regulation 2017.

### 6.1 Koala mapping

#### 6.1.1 Koala districts

The parts of Queensland where koalas are known to occur has been divided into three koala districts - koala district A, koala district B and koala district C. Each koala district is made up of areas with comparable koala populations (e.g. density, extent and significance of threatening processes affecting the population) which require similar management regimes.

Section 7.1 identifies which koala district your property is located in.

#### 6.1.2 Koala habitat areas

Koala habitat areas are areas of vegetation that have been determined to contain koala habitat that is essential for the conservation of a viable koala population in the wild based on the combination of habitat suitability and biophysical variables with known relationships to koala habitat (e.g. landcover, soil, terrain, climate and ground water). In order to protect this important koala habitat, clearing controls have been introduced into the Planning Regulation 2017 for development in koala habitat areas.

Please note that koala habitat areas only exist in koala district A which is the South East Queensland "Shaping SEQ" Regional Plan area. These areas include the local government areas of Brisbane, Gold Coast, Logan, Lockyer Valley, Ipswich, Moreton Bay, Noosa, Redland, Scenic Rim, Somerset, Sunshine Coast and Toowoomba (urban extent).

There are two different categories of koala habitat area (core koala habitat area and locally refined koala habitat), which have been determined using two different methodologies. These methodologies are described in the document [Spatial modelling in South East Queensland](#).

Section 7.2 shows any koala habitat area that exists on your property.

Under the Nature Conservation (Koala) Conservation Plan 2017, an owner of land (or a person acting on the owner's behalf with written consent) can request to make, amend or revoke a koala habitat area determination if they believe, on reasonable grounds, that the existing determination for all or part of their property is incorrect.

More information on requests to make, amend or revoke a koala habitat area determination can be found in the document [Guideline - Requests to make, amend or revoke a koala habitat area determination](#).

The koala habitat area map will be updated at least annually to include any koala habitat areas that have been made, amended or revoked.

Changes to the koala habitat area map which occur between annual updates because of a request to make, amend or revoke a koala habitat area determination can be viewed on the register of approved requests to make, amend or revoke a koala habitat area available at: <https://environment.des.qld.gov.au/wildlife/animals/living-with/koalas/mapping/koalamaps>. The register includes the lot on plan for the change, the date the decision was made and the map issued to the landholder that shows areas determined to be koala habitat areas.

#### 6.1.3 Koala priority areas

Koala priority areas are large, connected areas that have been determined to have the highest likelihood of achieving conservation outcomes for koalas based on the combination of habitat suitability, biophysical variables with known relationships to koala habitat (e.g. landcover, soil, terrain, climate and ground water) and a koala conservation cost benefit analysis.

Conservation efforts will be prioritised in these areas to ensure the conservation of viable koala populations in the wild including a focus on management (e.g. habitat protection, habitat restoration and threat mitigation) and monitoring. This includes a prohibition on clearing in koala habitat areas that are in koala priority areas under the Planning Regulation 2017 (subject to some exemptions).

Please note that koala priority areas only exist in koala district A which is the South East Queensland "Shaping SEQ" Regional Plan area. These areas include the local government areas of Brisbane, Gold Coast, Logan, Lockyer Valley,

Ipswich, Moreton Bay, Noosa, Redland, Scenic Rim, Somerset, Sunshine Coast and Toowoomba (urban extent).

Section 7.2 identifies if your property is in a koala priority area.

#### 6.1.4 Identified koala broad-hectare areas

There are seven identified koala broad-hectare areas in SEQ. These are areas of koala habitat that are located in areas committed to meet development targets in the SEQ Regional Plan to accommodate SEQ's growing population including bring-forward Greenfield sites under the Queensland Housing Affordability Strategy and declared master planned areas under the repealed *Sustainable Planning Act 2009* and the repealed *Integrated Planning Act 1997*.

Specific assessment benchmarks apply to development applications for development proposed in identified koala broad-hectare areas to ensure koala conservation measures are incorporated into the proposed development.

Section 7.2 identifies if your property is in an identified koala broad-hectare area.

## 6.2 Koala habitat planning controls

On 7 February 2020, the Queensland Government introduced new planning controls to the Planning Regulation 2017 to strengthen the protection of koala habitat in South East Queensland (i.e. koala district A).

More information on these planning controls can be found here:

<https://environment.des.qld.gov.au/wildlife/animals/living-with/koalas/mapping/legislation-policy>.

As a high-level summary, the koala habitat planning controls make:

- development that involves interfering with koala habitat (defined below) in an area that is both a koala priority area and a koala habitat area, prohibited development (i.e. development for which a development application cannot be made);
- development that involves interfering with koala habitat (defined below) in an area that is a koala habitat area but is not a koala priority area, assessable development (i.e. development for which development approval is required); and
- development that is for extractive industries where the development involves interfering with koala habitat (defined below) in an area that is both a koala habitat area and a key resource area, assessable development (i.e. development for which development approval is required).

**Interfering with koala habitat means:**

- 1) Removing, cutting down, ringbarking, pushing over, poisoning or destroying in anyway, including by burning, flooding or draining native vegetation in a koala habitat area; but
- 2) Does not include destroying standing vegetation by stock or lopping a tree.

However, these planning controls do not apply if the development is exempted development as defined in Schedule 24 of the [Planning Regulation 2017](#). More information on exempted development can be found here:

<https://environment.des.qld.gov.au/wildlife/animals/living-with/koalas/mapping/legislation-policy>.

There are also assessment benchmarks that apply to development applications for:

- building works, operational works, material change of use or reconfiguration of a lot where:
  - the local government planning scheme makes the development assessable;
  - the premises includes an area that is both a koala priority area and a koala habitat area; and
  - the development does not involve interfering with koala habitat (defined above); and
- development in identified koala broad-hectare areas.

The [Guideline - Assessment Benchmarks in relation to Koala Habitat in South East Queensland assessment benchmarks](#) outlines these assessment benchmarks, the intent of these assessment benchmarks and advice on how proposed development may meet these assessment benchmarks.

## 6.3 Koala Conservation Plan clearing requirements

Section 10 and 11 of the [Nature Conservation \(Koala\) Conservation Plan 2017](#) prescribes requirements that must be met when clearing koala habitat in koala district A and koala district B.

These clearing requirements are independent to the koala habitat planning controls introduced into the Planning Regulation 2017, which means they must be complied with irrespective of any approvals or exemptions offered under other legislation.

Unlike the clearing controls prescribed in the Planning Regulation 2017 that are to protect koala habitat, the clearing requirements prescribed in the Nature Conservation (Koala) Conservation Plan 2017 are in place to prevent the injury or death of koalas when koala habitat is being cleared.

## 6.4 Contact information for DES

For further information on the koala protection framework:

**Phone** 13 QGOV (13 74 68)

**Email** [koala.assessment@des.qld.gov.au](mailto:koala.assessment@des.qld.gov.au)

**Visit** <https://environment.des.qld.gov.au/wildlife/animals/living-with/koalas/mapping>

## 7. Koala protection framework details for Lot: 34 Plan: M341354

### 7.1 Koala districts





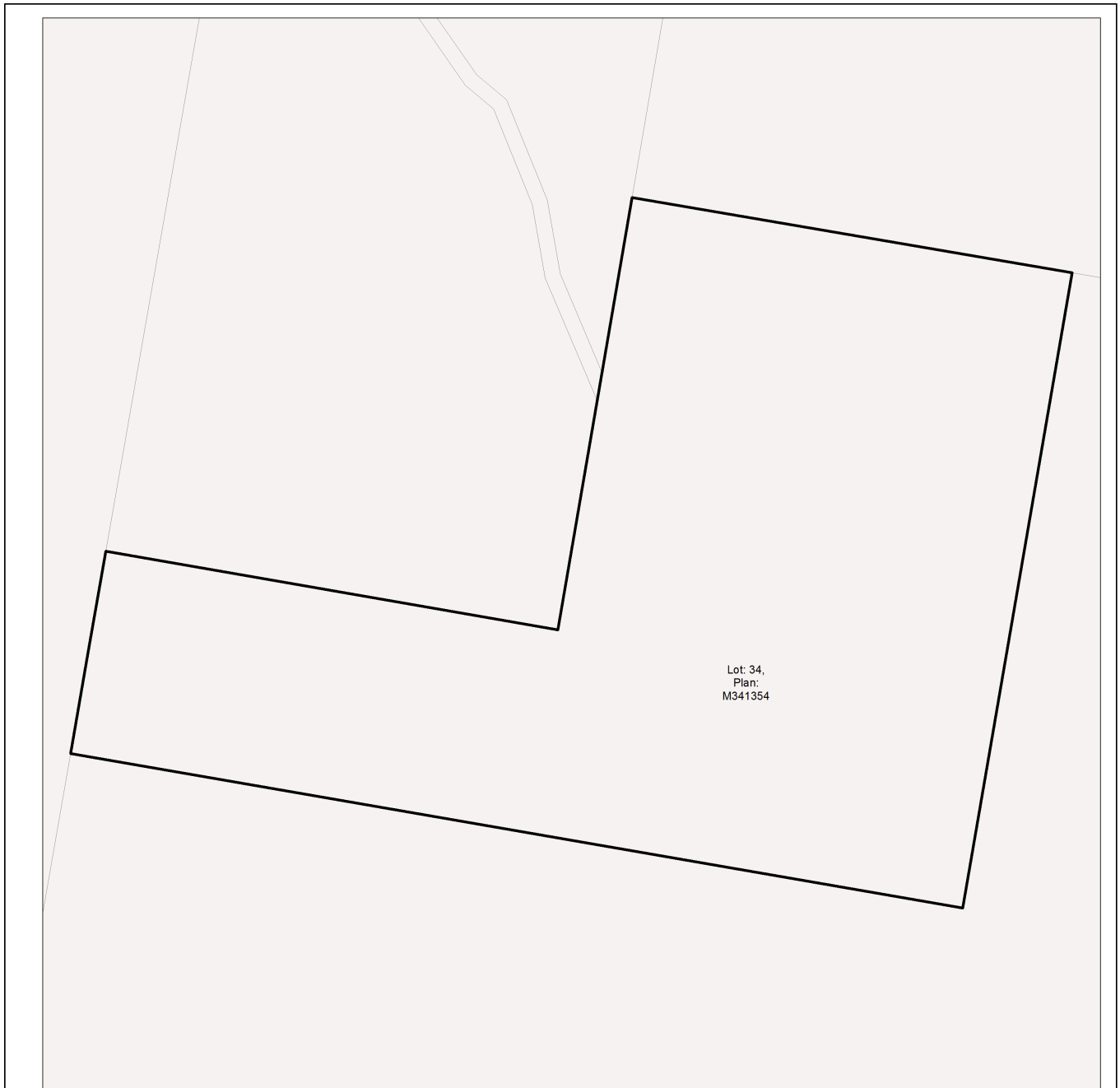







Koala District C

## 7.2 Koala priority area, koala habitat area and identified koala broad-hectare area map



### Koala priority area, koala habitat area and identified koala broad-hectare area map

#### Legend

-  Selected Lot and Plan
-  Koala habitat area (core)
-  Koala habitat area (locally refined)
-  Koala priority area
-  Identified koala broad-hectare area
-  Cadastral Boundaries
-  Towns
-  Highway
-  Connector
-  Street/Local Road
-  Major rivers/creeks
-  Queensland

The koala habitat mapping within South East Queensland uses regional ecosystem linework compiled at a scale varying from 1:25,000 to 1:100,000. Linework should be used as a guide only. The positional accuracy of regional ecosystem data mapped at a scale of 1:100,000 is +/- 100 metres.

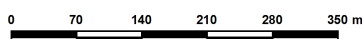
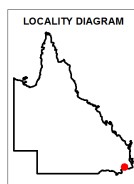

#### Disclaimer:

While every care is taken to ensure the accuracy of this product, the Department of Environment and Science acting on behalf of the State of Queensland makes no representations or warranties about its accuracy, reliability, completeness or suitability for any particular purpose and disclaims all responsibility and all liability (including without limitation, liability in negligence) for all expenses, losses, damages (including indirect or consequential damage) and costs which you might incur as a result of the data being inaccurate or incomplete in any way and for any reason. Due to varying sources of data, spatial locations may not coincide when overlaid.

The koala conservation plan maps will be updated at least annually to include any koala habitat areas that have been made, amended or revoked.

In order to ensure that the most recent map for an area of interest can be accessed, prior to the annual update, a register of changes made to koala habitat areas as a result of the map amendment process will be available at:  
<https://environment.des.qld.gov.au/wildlife/animals/living-with/koalas/mapping/>.  
 The register will include lot on plan for the change, the date the decision was made and the map issued to the landholder which shows areas determined to be koala habitat areas.





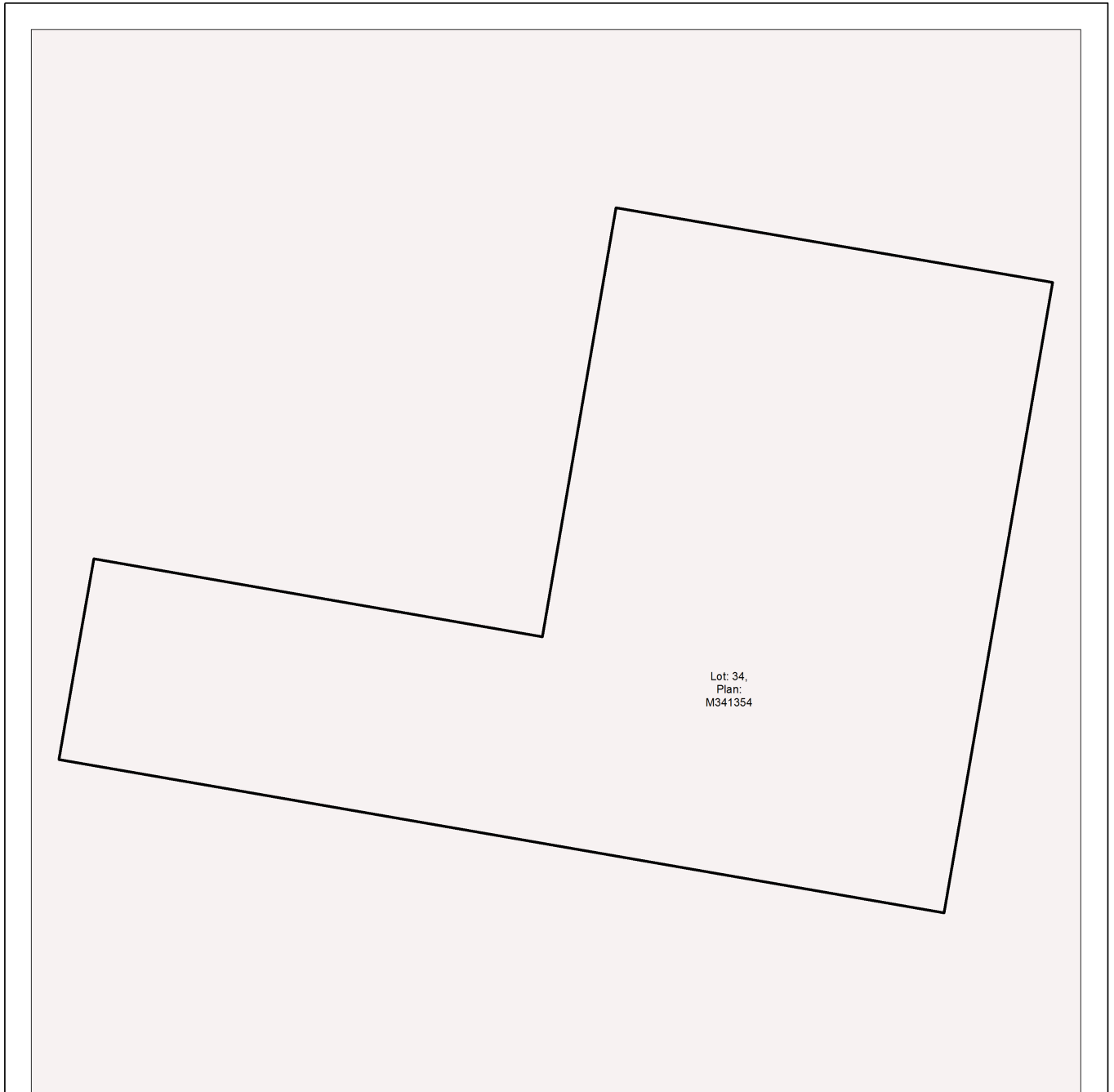





## 7.3 Koala habitat regional ecosystems for core koala habitat areas



### Koala habitat regional ecosystems for core koala habitat areas

**Legend**

-  Selected Lot and Plan
-  Koala habitat area (core)
-  Towns
-  Highway
-  Connector
-  Street/Local Road
-  Major rivers/creeks
-  Queensland



N

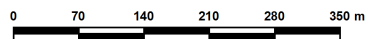

**DISCLAIMER:**

While every care is taken to ensure the accuracy of this product, the Department of Environment and Science acting on behalf of the State of Queensland makes no representations or warranties about its accuracy, reliability, completeness or suitability for any particular purpose and disclaims all responsibility and all liability (including without limitation, liability in negligence) for all expenses, losses, damages (including indirect or consequential damage) and costs which you might incur as a result of the data being inaccurate or incomplete in any way and for any reason. Due to varying sources of data, spatial locations may not coincide when overlaid.

The koala habitat mapping within South East Queensland uses regional ecosystem linework compiled at a scale varying from 1:25,000 to 1:100,000. Linework should be used as a guide only. The positional accuracy of regional ecosystem data mapped at a scale of 1:100,000 is +/- 100 metres.

© The State of Queensland, 2024

This product is projected into GDA 1994 MGA Zone 56

## 8. Other relevant legislation contacts list

Activity	Legislation	Agency	Contact details
<ul style="list-style-type: none"> <li>• Interference with overland flow</li> <li>• Earthworks, significant disturbance</li> </ul>	<i>Water Act 2000</i> <i>Soil Conservation Act 1986</i>	Department of Regional Development, Manufacturing and Water (Queensland Government) Department of Resources (Queensland Government)	Ph: 13 QGOV (13 74 68) <a href="http://www.rdmw.qld.gov.au">www.rdmw.qld.gov.au</a> <a href="http://www.resources.qld.gov.au">www.resources.qld.gov.au</a>
<ul style="list-style-type: none"> <li>• Indigenous Cultural Heritage</li> </ul>	<i>Aboriginal Cultural Heritage Act 2003</i> <i>Torres Strait Islander Cultural Heritage Act 2003</i>	Department of Seniors, Disability Services and Aboriginal and Torres Strait Islander Partnerships	Ph: 13 QGOV (13 74 68) <a href="http://www.datsip.qld.gov.au">www.datsip.qld.gov.au</a>
<ul style="list-style-type: none"> <li>• Mining and environmentally relevant activities</li> <li>• Infrastructure development (coastal)</li> <li>• Heritage issues</li> </ul>	<i>Environmental Protection Act 1994</i> <i>Coastal Protection and Management Act 1995</i> <i>Queensland Heritage Act 1992</i>	Department of Environment and Science (Queensland Government)	Ph: 13 QGOV (13 74 68) <a href="http://www.des.qld.gov.au">www.des.qld.gov.au</a>
<ul style="list-style-type: none"> <li>• Protected plants and protected areas</li> </ul>	<i>Nature Conservation Act 1992</i>	Department of Environment and Science (Queensland Government)	Ph: 1300 130 372 (option 4) <a href="mailto:palm@des.qld.gov.au">palm@des.qld.gov.au</a> <a href="http://www.des.qld.gov.au">www.des.qld.gov.au</a>
<ul style="list-style-type: none"> <li>• Koala mapping and regulations</li> </ul>	<i>Nature Conservation Act 1992</i>	Department of Environment and Science (Queensland Government)	Ph: 13 QGOV (13 74 68) <a href="mailto:Koala.assessment@des.qld.gov.au">Koala.assessment@des.qld.gov.au</a>
<ul style="list-style-type: none"> <li>• Interference with fish passage in a watercourse, mangroves</li> <li>• Forestry activities on State land tenures</li> </ul>	<i>Fisheries Act 1994</i> <i>Forestry Act 1959</i>	Department of Agriculture and Fisheries (Queensland Government)	Ph: 13 QGOV (13 74 68) <a href="http://www.daf.qld.gov.au">www.daf.qld.gov.au</a>
<ul style="list-style-type: none"> <li>• Matters of National Environmental Significance including listed threatened species and ecological communities</li> </ul>	<i>Environment Protection and Biodiversity Conservation Act 1999</i>	Department of Agriculture, Water and the Environment (Australian Government)	Ph: 1800 803 772 <a href="http://www.environment.gov.au">www.environment.gov.au</a>
<ul style="list-style-type: none"> <li>• Development and planning processes</li> </ul>	<i>Planning Act 2016</i> <i>State Development and Public Works Organisation Act 1971</i>	Department of State Development, Infrastructure, Local Government and Planning (Queensland Government)	Ph: 13 QGOV (13 74 68) <a href="http://www.dsdmip.qld.gov.au">www.dsdmip.qld.gov.au</a>
<ul style="list-style-type: none"> <li>• Local government requirements</li> </ul>	<i>Local Government Act 2009</i> <i>Planning Act 2016</i>	Department of State Development, Infrastructure, Local Government and Planning (Queensland Government)	Ph: 13 QGOV (13 74 68) Your relevant local government office
<ul style="list-style-type: none"> <li>• Harvesting timber in the Wet Tropics of Qld World Heritage area</li> </ul>	<i>Wet Tropics World Heritage Protection and Management Act 1993</i>	Wet Tropics Management Authority	Ph: (07) 4241 0500 <a href="http://www.wettropics.gov.au">www.wettropics.gov.au</a>